

Hack10 Clevis Clutch

The Hack10 clevis clutch is specifically designed as a chain shortening device for use in Hackett grade 10 chain sling assemblies. Featuring a clevis attachment type, this component connects to master links and sub assemblies via a connector and a short length of chain. This configuration offers greater flexibility than other chain shortening devices. Manufactured from alloy steel, the Hack10 clevis clutch is 25% stronger than a grade 8 equivalent, delivering a greater working load limit without the need for a larger diameter chain sling.

- Standards:** designed and manufactured in accordance with EN1677-1, ASTM A952/A952M, and DIN PAS 1061 and suitable for use in chain slings certified to EN818-4.
- Product sizes:** available for chain sizes from 8mm to 16mm and with working load limits from 2.5 tonnes to 10.0 tonnes.
- Temperature:** operational temperature range of - 40°C to + 200°C without reduction in working load limit.
- Material:** alloy steel.
- Testing:** crack detection following heat treatment, and proof load tested to 2.5 times working load limit.
- Safety factor:** 4 : 1.

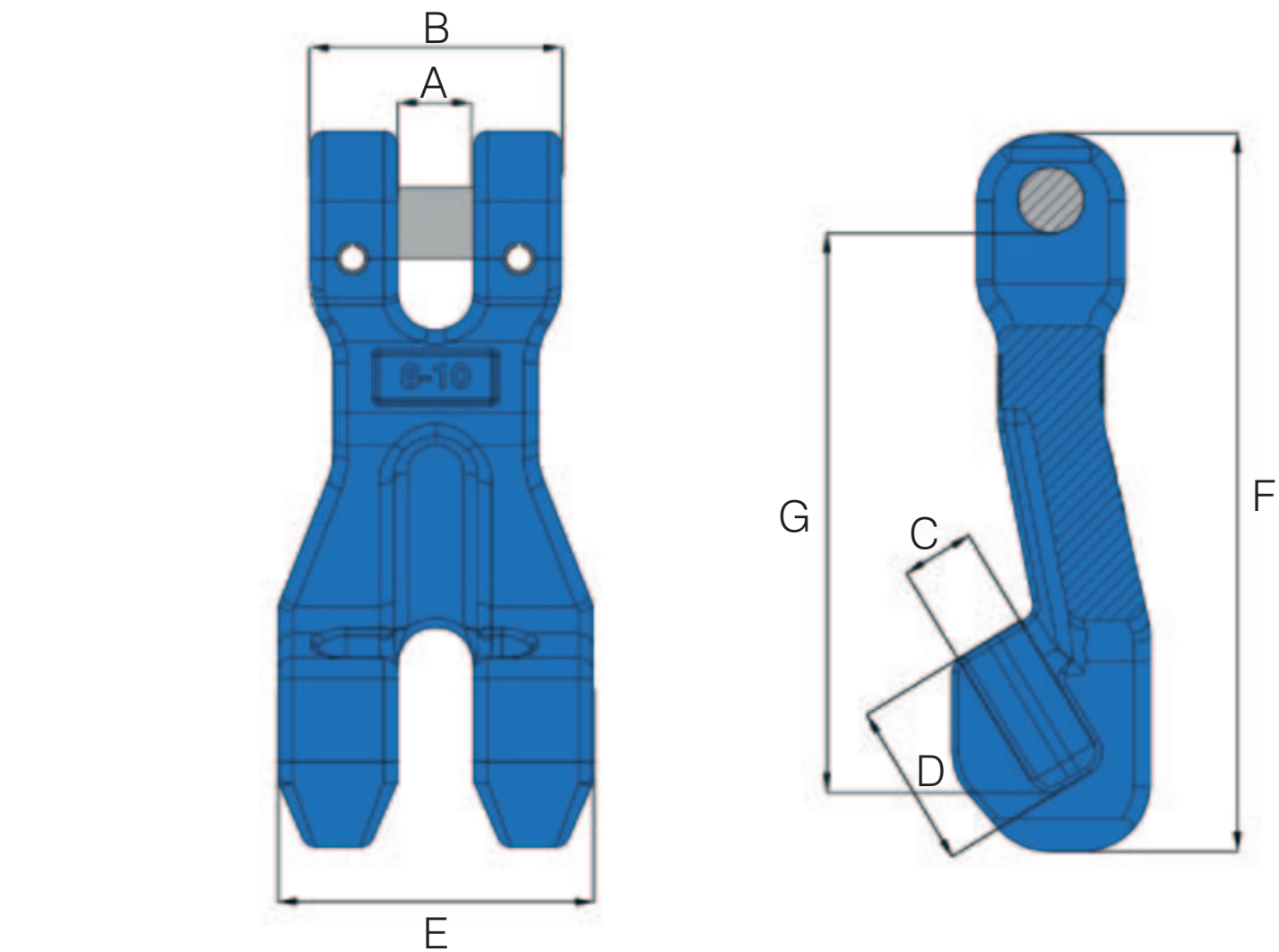

Metric Specifications

PART CODE	CHAIN SIZE mm	A mm	B mm	C mm	D mm	E mm	F mm	G mm	BOX QTY.	WLL tonnes	MASS kg
10-H10-08	8	9.5	36.0	10.5	17.0	45.0	101.0	70.0	50	2.5	0.37
10-H10-10	10	13.0	48.0	12.4	28.0	55.0	138.0	101.5	21	4.0	0.97
10-H10-13	13	16.5	59.0	16.0	34.5	75.0	177.0	115.0	10	6.7	2.01
10-H10-16	16	18.5	70.0	19.5	40.0	93.0	220.0	150.5	6	10.0	3.32